

BRACKISH WATER REVERSE OSMOSIS (RO) MEMBRANES



LG BW 400 AFR G2

Anti Fouling, High Rejection, High Flow, High Durability
Equipped with fouling tolerant low dP spacer technology



OVERVIEW

LG Chem's NanoH₂O™ brackish water RO membranes serve various municipal and industrial applications and have been operating in the major utilities around the world. Incorporating innovative Thin Film Nanocomposite (TFN) technology, all LG BWRO membranes provide superior performance along with intrinsic anti-fouling property and are suitable for applications where consistent and reliable performance is a must.

LG BW 400 AFR G2 membranes offer a combination of enhanced fouling resistance, high rejection, flow, durability and reduce total cost of ownership: suitable for high salinity brackish water and wastewater reuse applications with a challenging feed water. LG BW 400 AFR G2 membranes incorporate state of the art feed spacer technology, which can greatly reduce differential pressure and cleaning frequency.

PRODUCT SPECIFICATIONS

Active Membrane Area, ft ² (m ²)	Permeate Flow Rate, GPD (m ³ /d)	Stabilized Salt Rejection, %	Minimum Salt Rejection, %	Feed Spacer, mil
400 (37)	11,500 (43.5)	99.7	99.6	34, low dP

Test Conditions : 2,000 ppm NaCl at 25°C (77°F), 225 psi (15.5 bar), pH 7, Recovery 15%.
Permeate flows for individual elements may vary +/-15%.

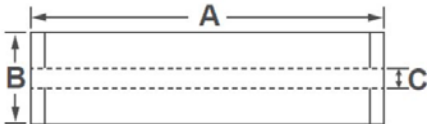

A, mm (in.)	B, mm (in.)	C, mm (in.)	Weight kg (lbs.)
1,016 (40)	200 (7.9)	28.6 (1.125)	16 (35)

OPERATING SPECIFICATIONS

Max. Applied pressure	600 psi (41 bar)
Max. Chlorine concentration	< 0.1 ppm
Max. Operating temperature	45°C (113°F)
pH Range, Continuous (Cleaning)	2-11 (1-13)
Max. Feedwater turbidity	1.0 NTU
Max. Feedwater SDI (15 mins)	5.0
Max. Feed flow	75 gpm (17 m ³ /h)
Max. Pressure drop (ΔP) for each element	15 psi (1.0 bar)

The information and data contained herein are deemed to be accurate and reliable and are offered in good faith, but without guarantee of performance. Please contact Aqua-chem for expert advice and technical support.



CONTACT US:
(800) 964-7035
sales@aqua-chem.com
www.aqua-chem.com